

Notice of works – Bottom House Farm Lane

August 2020 | www.hs2.org.uk

Notification



High Speed Two (HS2) is the new high speed railway for Britain. We are continually reviewing the works on our construction sites in line with Government and Public Health England (PHE) advice on dealing with COVID-19. The Government's current strategy makes it clear that construction activity can continue as long as it complies with this guidance. Please be assured that only sites that can operate within the guidelines are operational. All sites will remain under constant review. We have postponed all face-to-face engagement events and meetings and have put in place a number of channels to communicate with communities, such as letters and phone calls, as well as updates and alerts from each of the local community websites. You can sign up for regular updates in your local area at www.hs2inbucksandox.co.uk

This notice is providing an update on the works following the impact and subsequent delay from COVID-19. We wrote to you previously in May regarding the works that we need to undertake on the A413 at the junction with Bottom House Farm Lane. The previous May notice carries the reference number: FUS_AWN_0075.

As many of you are already aware Bottom House Farm Lane in Chalfont St Giles will be the site of one of the Chiltern Tunnel's ventilation shafts, which will be located about a mile from its junction with the A413. To access the site safely we are building a new temporary access road as the existing lane is too narrow for Heavy Good Vehicles (HGVs) to use. Works have been ongoing on the lane over the last few months constructing the temporary access road, however due to the impact of COVID-19 on third party providers the junction construction at the A413 have been delayed.

If you have a question about HS2 or our works, please contact our HS2 Helpdesk team on 08081 434 434 or email hs2enquiries@hs2.org.uk

Duration of works

End of August 2020 until mid November 2020

Monday to Friday 8am – 6pm and Saturday 8am – 1pm

We may also be on site for one hour's quiet start up and shutdown outside of these times

What to expect

Access road construction

Junction construction

Vehicle movements along the lane

Speed restriction on A413

A413 lane closures

What we will do

Respond promptly to any queries or complaints and take appropriate action

Clean the lane regularly to minimise mud on the road surface as much as possible and control dust

Notice of works – Bottom House Farm Lane

Notification



www.hs2.org.uk

Junction of Bottom House Farm Lane and A413

A new signalised junction is to be created with the A413 to replace the existing Bottom House Farm Lane junction during the construction of the vent shaft. The junction construction needs traffic management on the A413 and Bottom House Farm Lane. This will involve different phases.

Phase one works – beginning end of August 2020

The Amersham bound lane of the A413 will remain closed with the A413 reduced to a single lane under 24 hour traffic light operation. The closed lane is required to create a safe working area to start the construction of the new junction bell mouth in the existing verge. During this time the existing Bottom House Farm Lane access will remain open for public and HS2 traffic with three way traffic lights installed to provide safe controlled access onto the A413.

Works will be done during the day where possible to reduce night time disturbance in the area and in response to current reduced traffic flow.

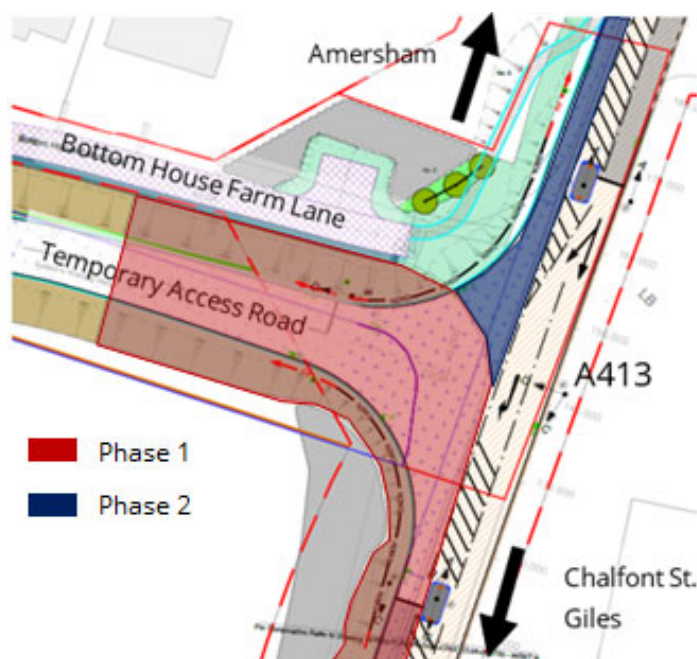

Phase two works – October 2020 to mid November 2020

Phase two works will commence shortly after the completion of phase one. Elements of the construction for phase two will involve the closure of the existing Bottom House Farm Lane, however local access will still be available using the partially completed new junction.

Contact our HS2 Helpdesk team on [08081 434 434](tel:08081434434)

Notice of utility works – Bottom House Farm Lane

www.hs2.org.uk

Notification



Why are the works taking place now?

Due to the impact of COVID-19 the third party providers carrying out the utility diversion have been unable to carry out utility diversions until now. These works needed to take place ahead of the main junction construction activity with the A413.

A413 speed restriction

As advised in previous notices, a 40mph speed limit has been introduced on the A413 around the Bottom House Farm Lane junction to enable works on the existing verge and lane to be carried out. The speed restriction will remain for the period of the junction works and the operation of junction for the construction of the vent shaft.

Keeping you informed

We are committed to keeping you informed about work on HS2. This includes ensuring you know what to expect and when to expect it, as well as how we can help.

Residents' Charter and Commissioner

The Residents' Charter is our promise to communicate as clearly as we possibly can with people who live along or near the HS2 route. www.gov.uk/government/publications/hs2-residents-charter

We also have an independent Residents' Commissioner whose job is to make sure we keep to the promises we make in the Charter and to keep it under constant review. Find reports at: www.gov.uk/government/collections/hs2-ltd-residents-commissioner

You can contact the Commissioner at: residentscommissioner@hs2.org.uk

Construction Commissioner

The Construction Commissioner's role is to mediate and monitor the way in which HS2 Ltd manages and responds to construction complaints. You can contact the Construction Commissioner by emailing: complaints@hs2-cc.org.uk

Property and compensation

You can find out all about HS2 and properties along the line of route by visiting: www.gov.uk/government/collections/hs2-property
Find out if you're eligible for compensation at: www.gov.uk/claim-compensation-if-affected-by-hs2

Holding us to account

If you are unhappy for any reason you can make a complaint by contacting our HS2 Helpdesk team. For more details on our complaints process, please visit our website: www.hs2.org.uk/how-to-complain

Contact Us

Contact our HS2 Helpdesk team all day, every day of the year on:

 Freephone **08081 434 434**

 Minicom **08081 456 472**

 Email **hs2enquiries@hs2.org.uk**

Write to:

FREEPOST

HS2 Community Engagement

Website **www.hs2.org.uk**

To keep up to date with what is happening in your local area, visit: **www.hs2inyourarea.co.uk**

Please contact us if you'd like a free copy of this document in large print, Braille, audio or easy read. You can also contact us for help and information in a different language.

HS2 Ltd is committed to protecting personal information. If you wish to know more about how we use your personal information please see our Privacy Notice <https://www.gov.uk/government/publications/high-speed-two-ltd-privacy-notice>

Reference number: FUS_AWN_0105 HS2-EW-FUS-Ph1-Ar-Ce-C1-Traf-31-18/08/2020

High Speed Two (HS2) Limited, registered in England and Wales.
Registered office: Two Snowhill, Snow Hill Queensway, Birmingham B4 6GA.
Company registration number: 06791686. VAT registration number: 888 8512 56.